

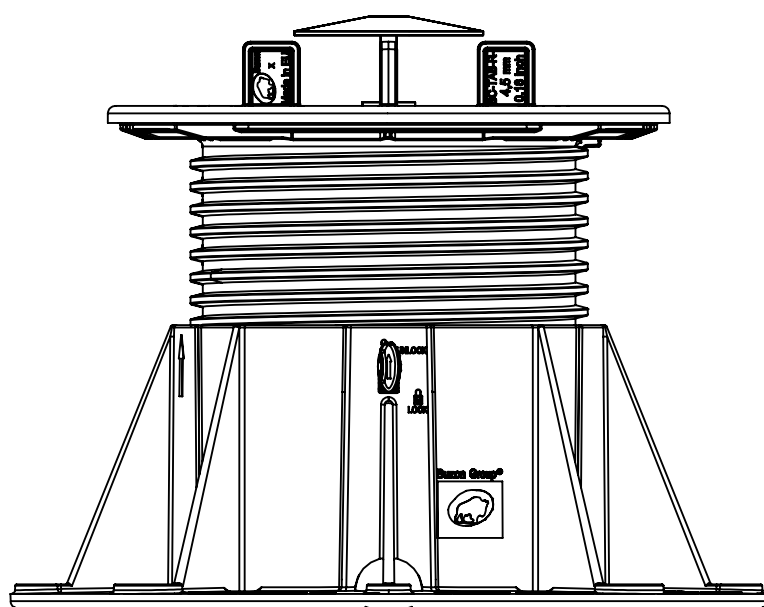

Buzon UK Ltd  
Unit 6  
Teddington Business Park  
Station Road  
Teddington  
TW11 9BQ

Scale :1:2

**BC-4 + BC-TAB-R-4.5MM-H17  
+ PB-KIT-1 + WASHER stainless steel**  
FOR 20 MM THICKNESS GRES-CERAM PORCELAIN TILES ONLY



FRONT VIEW

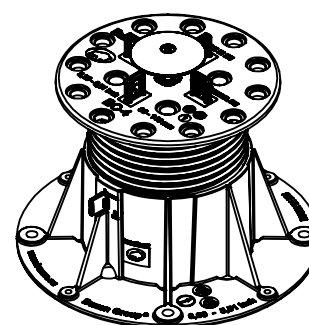

ISOMETRIC VIEW scale :1:5

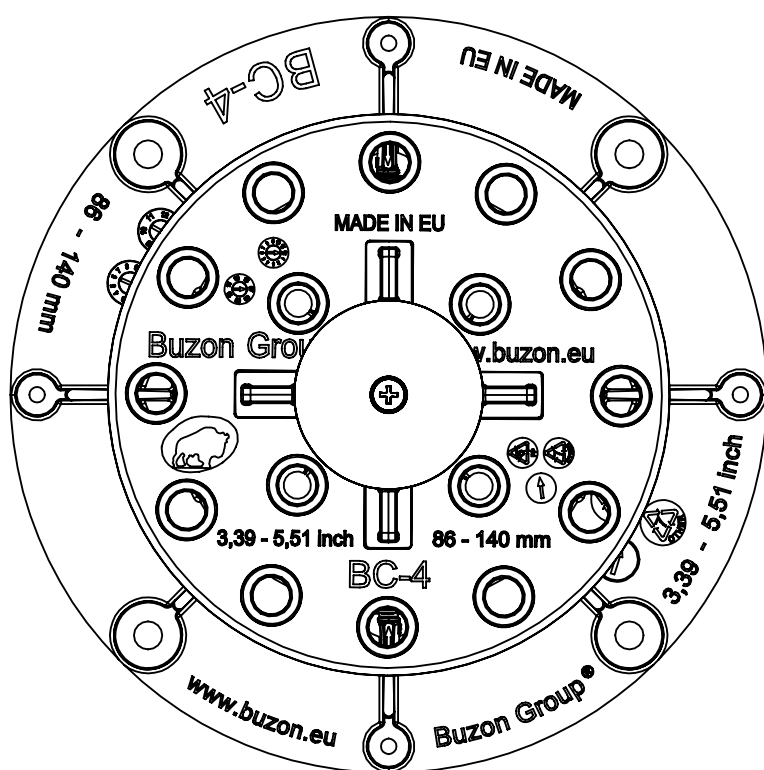

TOP VIEW

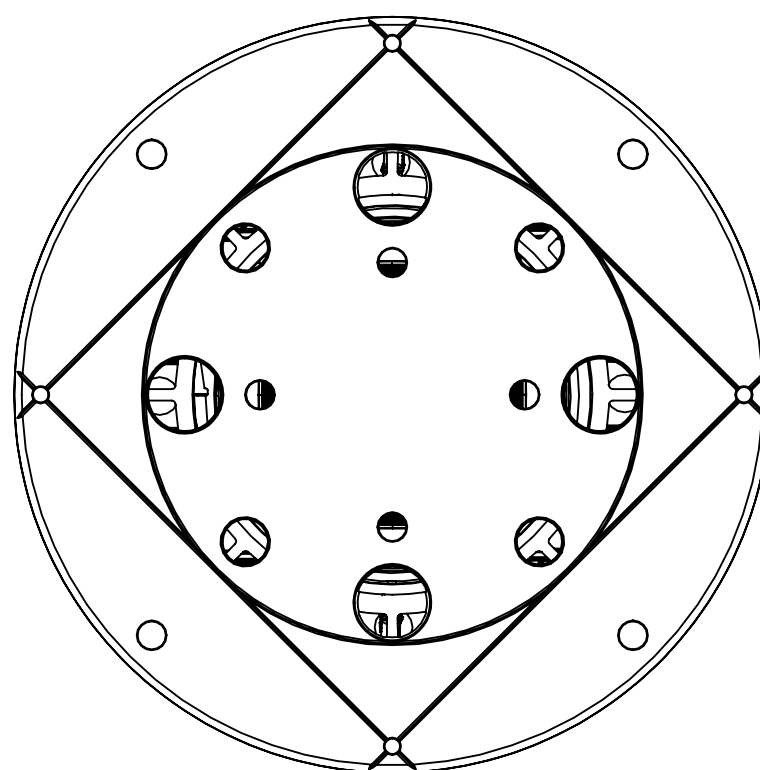

BOTTOM VIEW

**SPECIFICATIONS:**

**TRACTION TEST:** 50Kg/490N/110lbf/\*TEST AVAILABLE ON REQUEST  
**BUZON SECURITY VALUE :** DIVIDE THE LOAD INDICATED BY 2 = 25Kg/245N/55lbf  
**BC-4:** REFERRING TO TECHNICAL DATA SHEET.  
**BC-TAB-R-4,5MM-H17 :** REFERRING TO TECHNICAL DATA SHEET.  
**PB-KIT-1 + WASHER stainless steel:** REFERRING TO TECHNICAL DATA SHEET.  
**TECHNICAL INFORMATION:** REFERRING TO TECHNICAL DATA SHEET.

**NOTES:**

1. INSTALLATION TO BE COMPLETED IN ACCORDANCE WITH MANUFACTURER'S SPECIFICATIONS.
2. SCALE DRAWING.
3. THIS DRAWING IS INTENDED FOR USE BY ARCHITECTS, ENGINEERS, CONTRACTORS, CONSULTANTS AND DESIGN PROFESSIONALS FOR PLANNING PURPOSES ONLY. THIS DRAWING MAY NOT BE USED FOR CONSTRUCTION.
4. ALL INFORMATION CONTAINED HEREIN WAS CURRENT AT THE TIME OF DEVELOPMENT, BUT MUST BE REVIEWED AND APPROVED BY THE PRODUCT MANUFACTURER TO BE CONSIDERED ACCURATE.

## BC-4--85-139mm

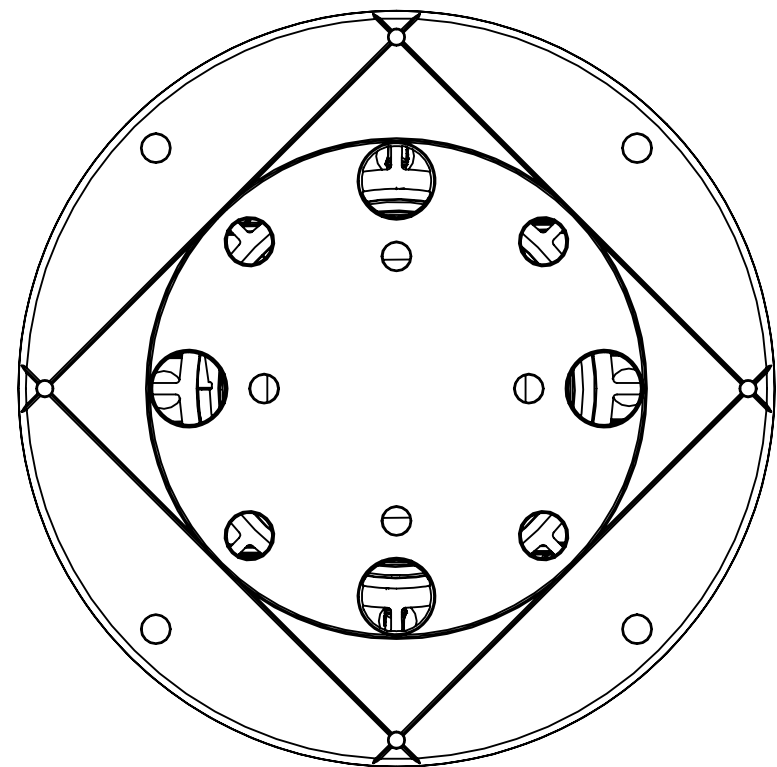
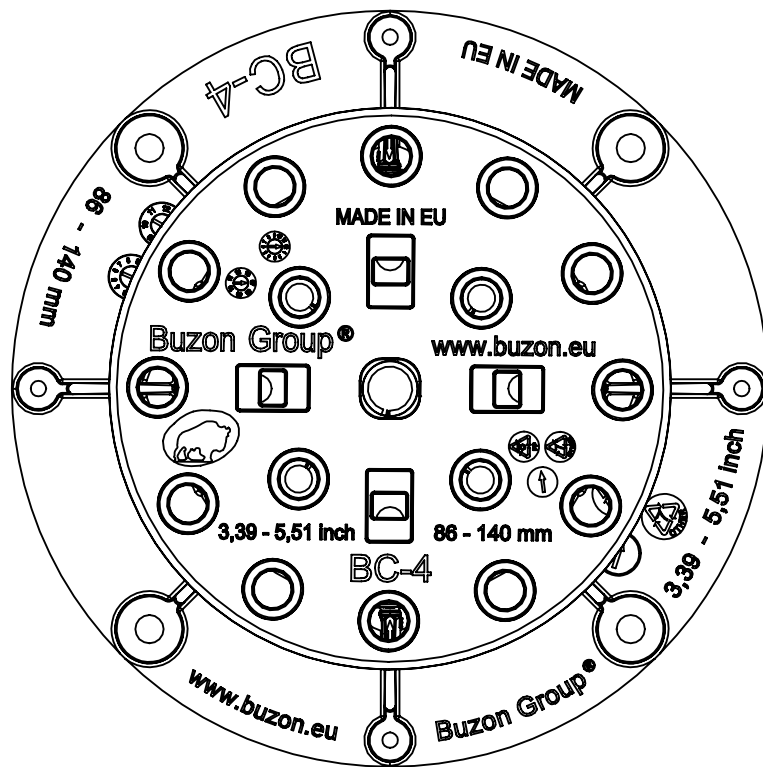
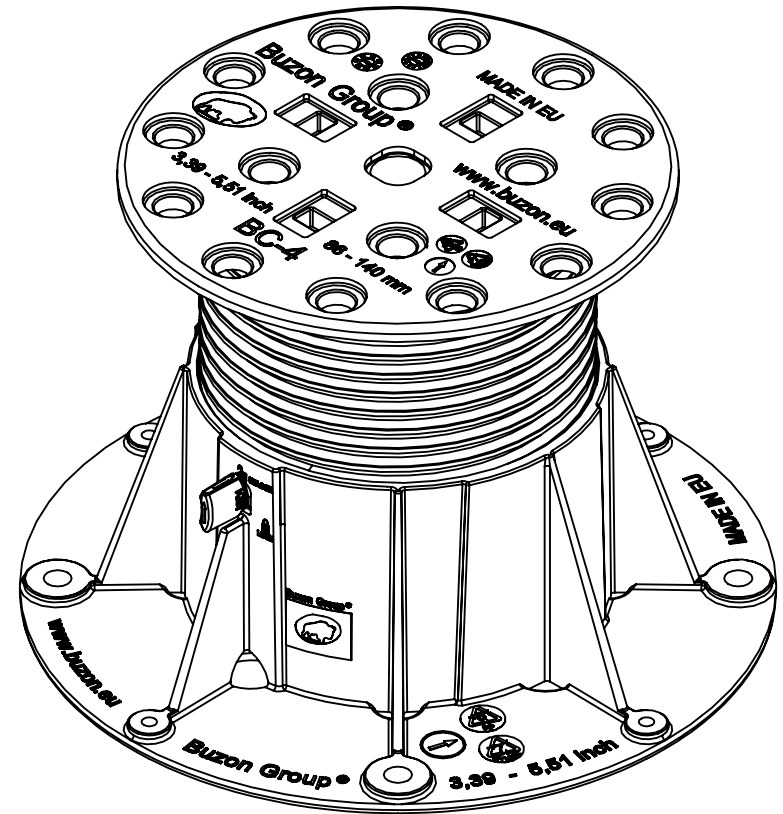
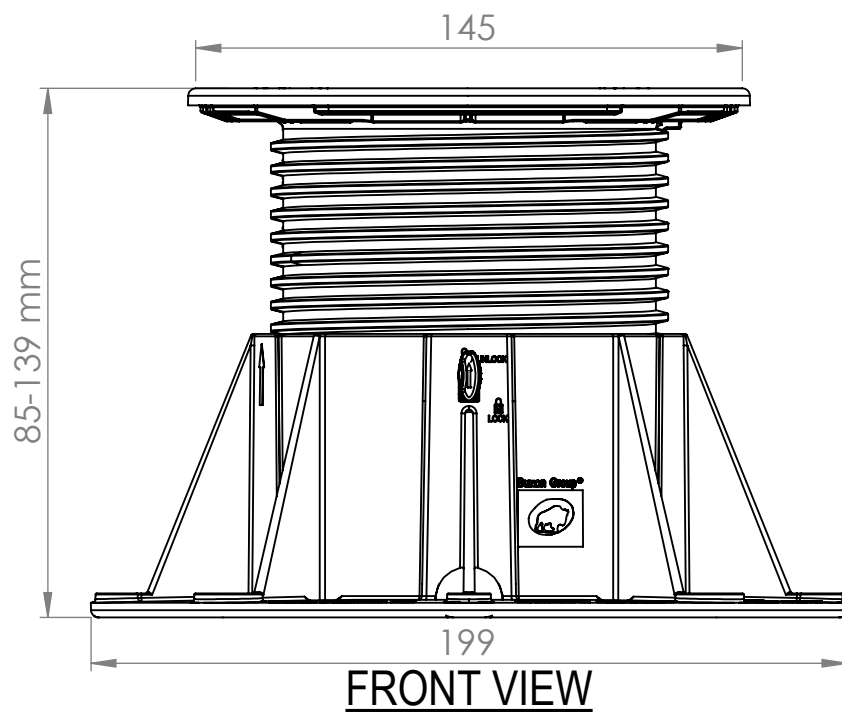

### **SPECIFICATION:**

**ADJUSTABLE HEIGHT:** ADJUSTABLE HEIGHT FROM 85 MM TO 139 MM UNINTERRUPTED.

WITH ADDITION OF A 0 TO 5% BC-PH5 SLOPE CORRECTOR, ADJUSTABLE FROM 97 TO 151 MM.

**COMPOSITION:** THE BC-4 IS COMPOSED OF 2 PIECES (HEAD + BASE) + 2 SECURITY LOCKING KEYS.

**DIMENSIONS:** HEAD = DIAMETER 145 MM, INSTALLATION SURFACE 165 CM<sup>2</sup>.

BASE = DIAMETER 199 MM, GROUND SURFACE 311 CM<sup>2</sup>.

FULL WATER DRAINAGE SYSTEM.

**MANUFACTURE:** INJECTION MOULDING, >PP<, TOLERANCE MEASUREMENT = ± 1 MM.

**TECHNICAL INFORMATION:** REFERRING TO TECHNICAL DATA SHEET.

### **NOTES:**

1. INSTALLATION TO BE COMPLETED IN ACCORDANCE WITH MANUFACTURER'S SPECIFICATIONS.
2. SCALE DRAWING.
3. THIS DRAWING IS INTENDED FOR USE BY ARCHITECTS, ENGINEERS, CONTRACTORS, CONSULTANTS AND DESIGN PROFESSIONALS FOR PLANNING PURPOSES ONLY. THIS DRAWING MAY NOT BE USED FOR CONSTRUCTION.
4. ALL INFORMATION CONTAINED HEREIN WAS CURRENT AT THE TIME OF DEVELOPMENT, BUT MUST BE REVIEWED AND APPROVED BY THE PRODUCT MANUFACTURER TO BE CONSIDERED ACCURATE.



Scale :2:1

## PB-KIT-1 + WASHER Ø 35 mm stainless steel FOR 20 MM THICKNESS GRES-CERAM PORCELAIN TILES ONLY

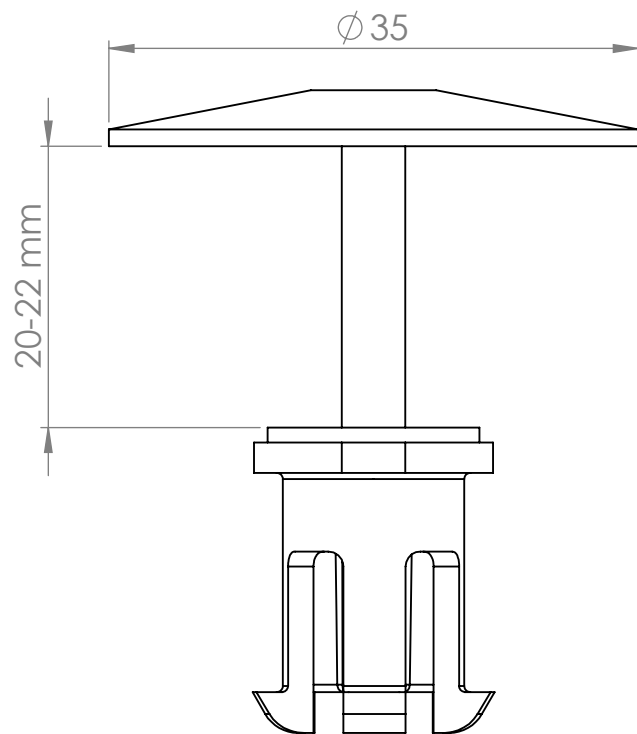

FRONT VIEW

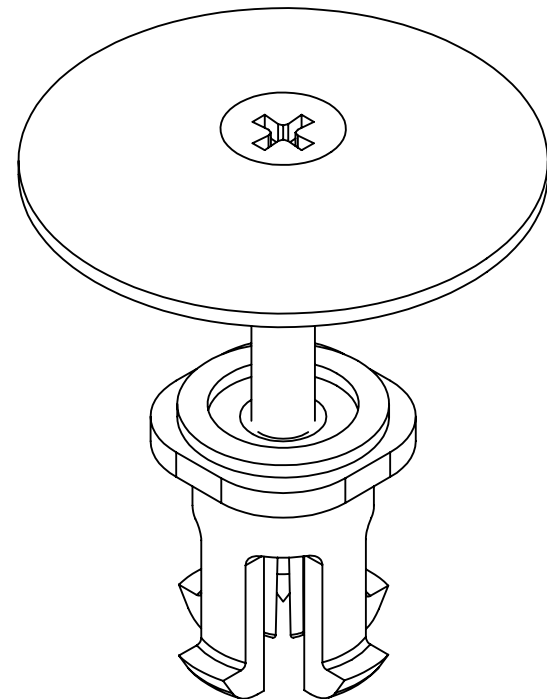

ISOMETRIC VIEW

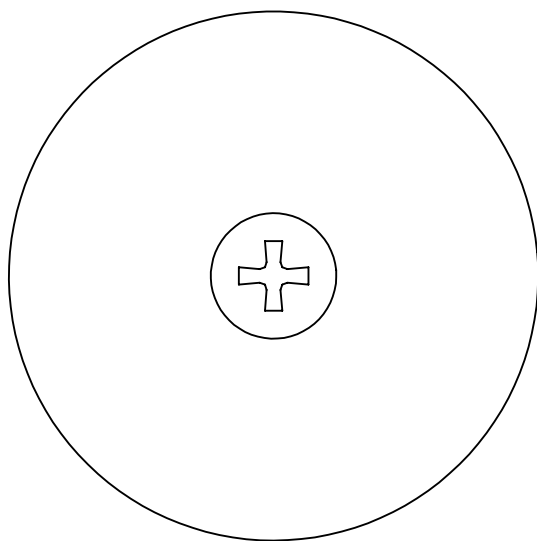

TOP VIEW

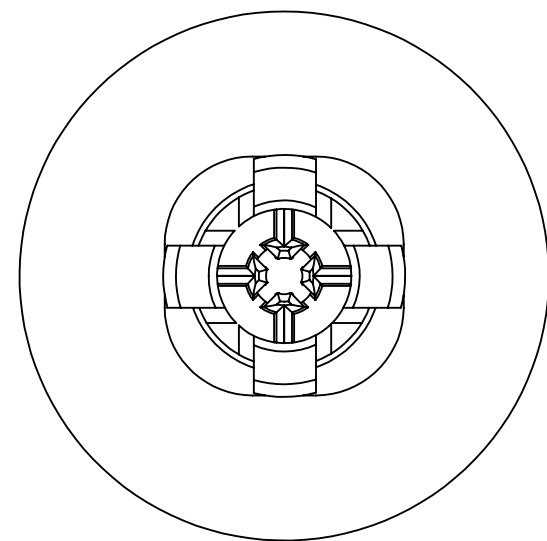

BOTTOM VIEW

### **SPECIFICATION:**

**TRACTION TEST:** 50Kg/490N/110lbf/\*TEST AVAILABLE ON REQUEST

**BUZON SECURITY VALUE :** DIVIDE THE LOAD INDICATED BY 2 = 25Kg/245N/55lbf

**APPLICATION:** APPLICABLE FROM BC-02 TO BC-12.

FOR 20 MM THICKNESS GRES-CERAM PORCELAIN TILES ONLY.

**COMPOSITION:** THE BC-KIT-WR IS COMPOSED OF 3 PIECE :

1. PB-KIT-1
2. SELF-TAPPING SCREW, WURTH N°012724245, STAINLESS STEEL A4, Ø = 4,2 MM, L = 45 MM
3. WASHER Ø 35 mm, STAINLESS STEEL 316.

FULL WATER DRAINAGE SYSTEM.

**TECHNICAL INFORMATION:** REFERRING TO TECHNICAL DATA SHEET.

### **NOTES:**

1. INSTALLATION TO BE COMPLETED IN ACCORDANCE WITH MANUFACTURER'S SPECIFICATIONS.
2. SCALE DRAWING.
3. THIS DRAWING IS INTENDED FOR USE BY ARCHITECTS, ENGINEERS, CONTRACTORS, CONSULTANTS AND DESIGN PROFESSIONALS FOR PLANNING PURPOSES ONLY. THIS DRAWING MAY NOT BE USED FOR CONSTRUCTION.
4. ALL INFORMATION CONTAINED HEREIN WAS CURRENT AT THE TIME OF DEVELOPMENT, BUT MUST BE REVIEWED AND APPROVED BY THE PRODUCT MANUFACTURER TO BE CONSIDERED ACCURATE.



Scale :2:1

## PB-KIT-1 + WASHER Ø 50 mm stainless steel FOR 20 MM THICKNESS GRES-CERAM PORCELAIN TILES ONLY

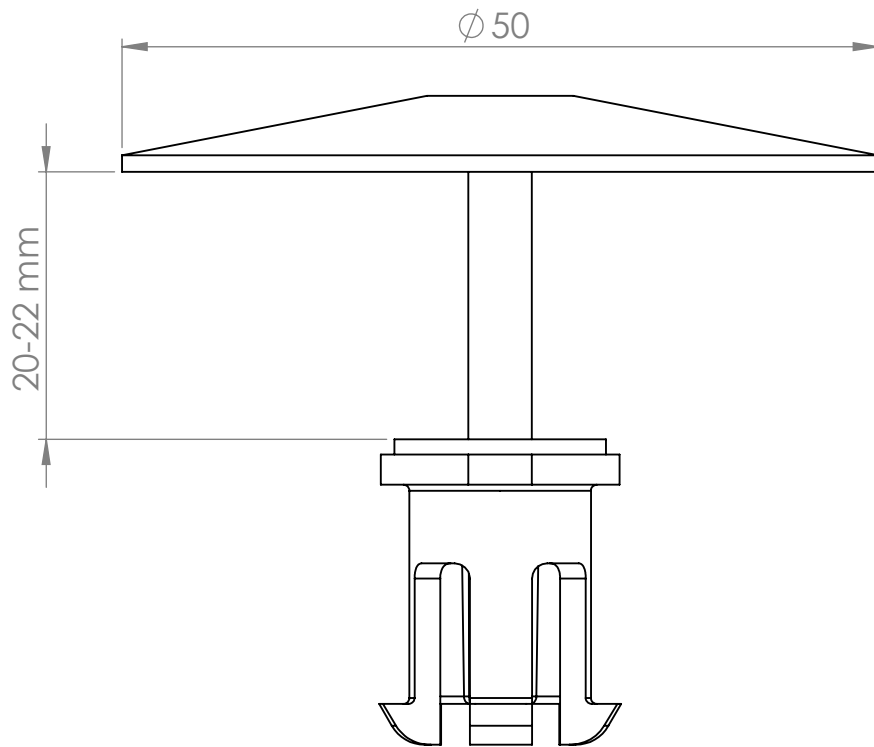

FRONT VIEW

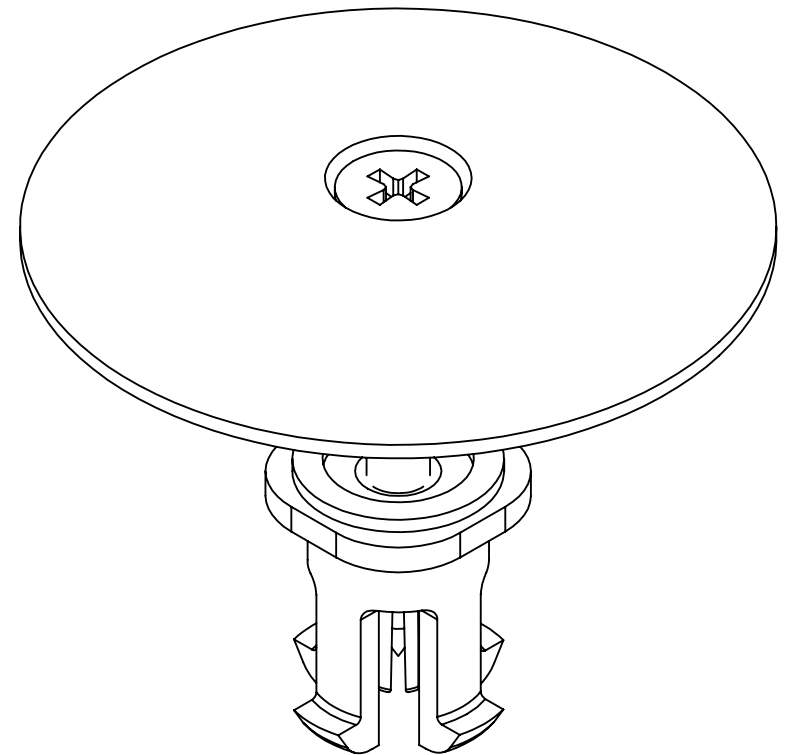

ISOMETRIC VIEW

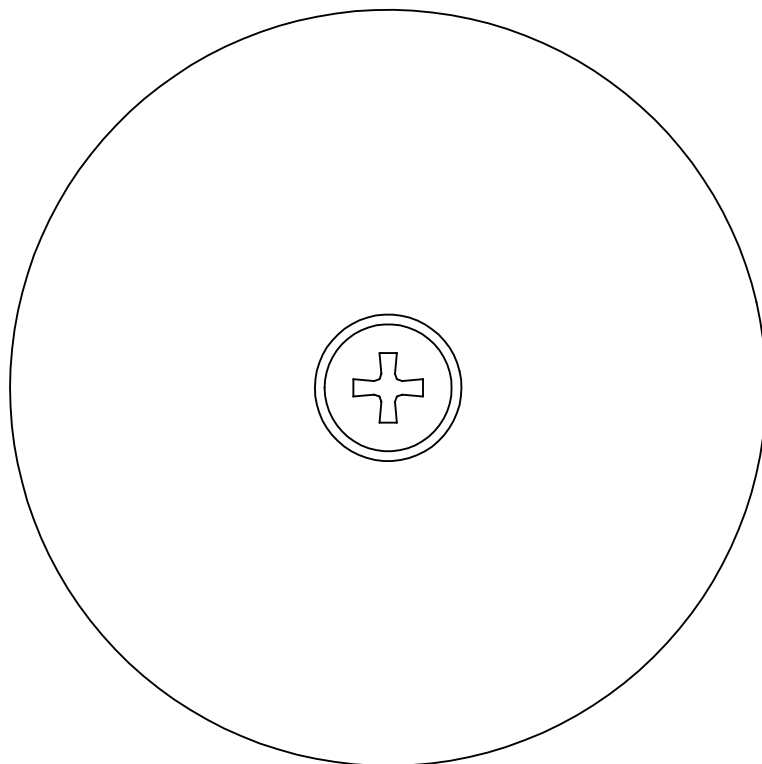

TOP VIEW

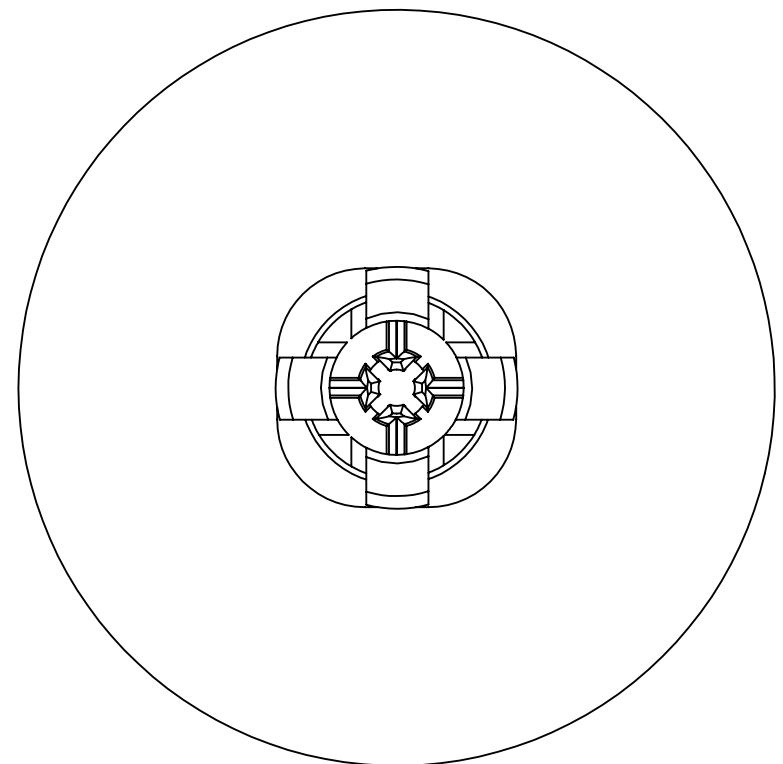

BOTTOM VIEW

### **SPECIFICATION:**

**TRACTION TEST:** 50Kg/490N/110lbf/\*TEST AVAILABLE ON REQUEST

**BUZON SECURITY VALUE :** DIVIDE THE LOAD INDICATED BY 2 = 25Kg/245N/55lbf

**APPLICATION:** APPLICABLE FROM BC-02 TO BC-12.

**FOR 20 MM THICKNESS GRES-CERAM PORCELAIN TILES ONLY.**

**COMPOSITION:** THE BC-KIT-WR IS COMPOSED OF 3 PIECE :

1. PB-KIT-1
2. SELF-TAPPING SCREW, WURTH N°012724245, STAINLESS STEEL A4, Ø = 4,2 MM, L = 45 MM
3. WASHER Ø 50 mm, STAINLESS STEEL 316.

FULL WATER DRAINAGE SYSTEM.

**TECHNICAL INFORMATION:** REFERRING TO TECHNICAL DATA SHEET.

### **NOTES:**

1. INSTALLATION TO BE COMPLETED IN ACCORDANCE WITH MANUFACTURER'S SPECIFICATIONS.
2. SCALE DRAWING.
3. THIS DRAWING IS INTENDED FOR USE BY ARCHITECTS, ENGINEERS, CONTRACTORS, CONSULTANTS AND DESIGN PROFESSIONALS FOR PLANNING PURPOSES ONLY. THIS DRAWING MAY NOT BE USED FOR CONSTRUCTION.
4. ALL INFORMATION CONTAINED HEREIN WAS CURRENT AT THE TIME OF DEVELOPMENT, BUT MUST BE REVIEWED AND APPROVED BY THE PRODUCT MANUFACTURER TO BE CONSIDERED ACCURATE.



Scale :2:1

## PB-KIT-1

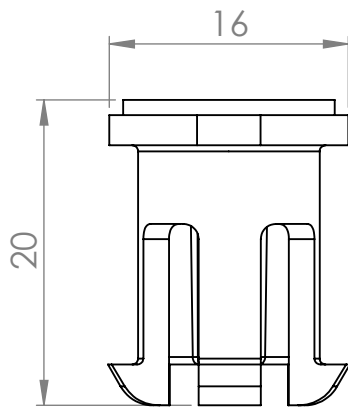

FRONT VIEW

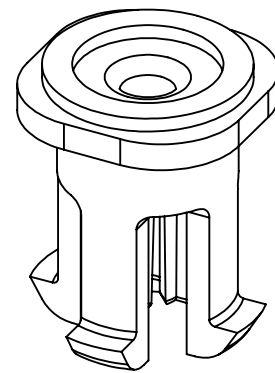

ISOMETRIC VIEW

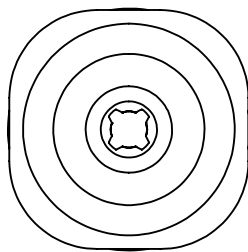

TOP VIEW

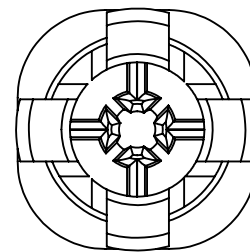

BOTTOM VIEW

**SPECIFICATION:**

**TRACTION TEST:** 50Kg/490N/110lbf/\*TEST AVAILABLE ON REQUEST

**BUZON SECURITY VALUE :** DIVIDE THE LOAD INDICATED BY 2 = 25Kg/245N/55lbf

**APPLICATION:** APPLICABLE FROM BC-02 TO BC-12.

**COMPOSITION:** THE PB-KIT-1 IS COMPOSED OF 1 PIECE.

**FULL WATER DRAINAGE SYSTEM.**

**TECHNICAL INFORMATION:** REFERRING TO TECHNICAL DATA SHEET.

**NOTES:**

1. INSTALLATION TO BE COMPLETED IN ACCORDANCE WITH MANUFACTURER'S SPECIFICATIONS.
2. SCALE DRAWING.
3. THIS DRAWING IS INTENDED FOR USE BY ARCHITECTS, ENGINEERS, CONTRACTORS, CONSULTANTS AND DESIGN PROFESSIONALS FOR PLANNING PURPOSES ONLY. THIS DRAWING MAY NOT BE USED FOR CONSTRUCTION.
4. ALL INFORMATION CONTAINED HEREIN WAS CURRENT AT THE TIME OF DEVELOPMENT, BUT MUST BE REVIEWED AND APPROVED BY THE PRODUCT MANUFACTURER TO BE CONSIDERED ACCURATE.

# Datasheet WR

## washer stainless steel

50 mm

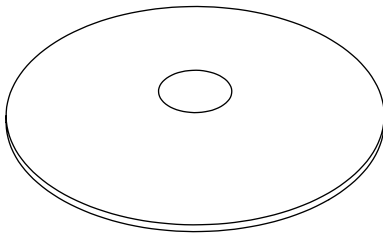
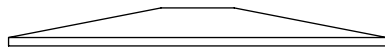
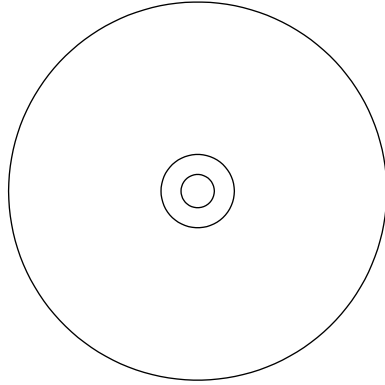

35 mm

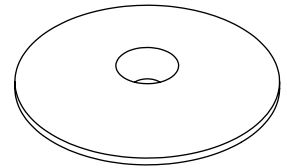
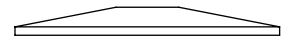
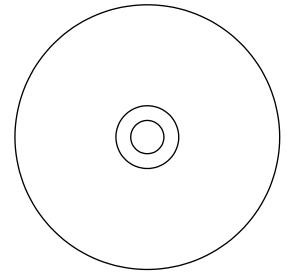

### **Characteristics**

Material	Stainless steel 316 (A4)
Dimensions	Ø50 x h3.7 mm Ø35 x h3.7 mm
Colour	Natural stainless steel
Weight	Ø 50 mm 17gr Ø 35 mm 9 gr
E-modulus	ca. 180000 N/mm2

# Datasheet

## WR washer POM

50 mm

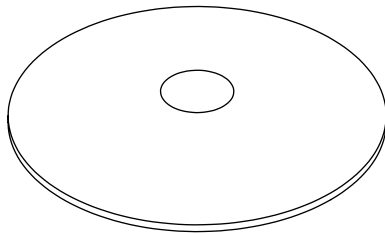
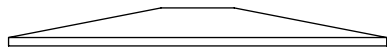
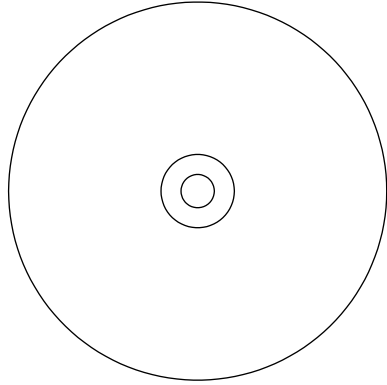

35 mm

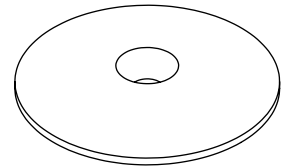
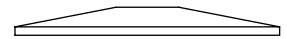
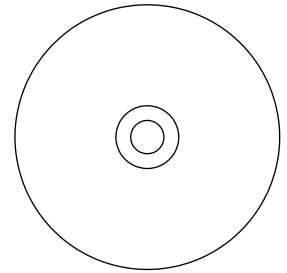

### Characteristics

Material	POM
Dimensions	Ø50 x h4.8mm Ø35 x h4.9mm
Colour	Differents colors
Weight	Ø 50 mm 7gr Ø 35 mm 5gr



# Datasheet

## Screw WR washer

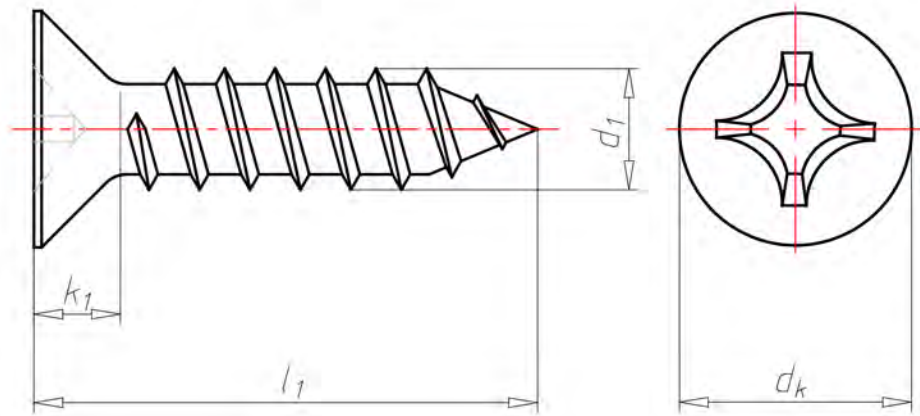

### Characteristics

Art N° Wuerth	012724245
Material	Stainless steel (A4)
Colour	Natural stainless steel
Dimensions	$d_1 = 4.2\text{mm}$ $l_1 = 45\text{ mm}$ $k_1 = 2.6\text{mm}$ $d_k = 8.4\text{mm}$



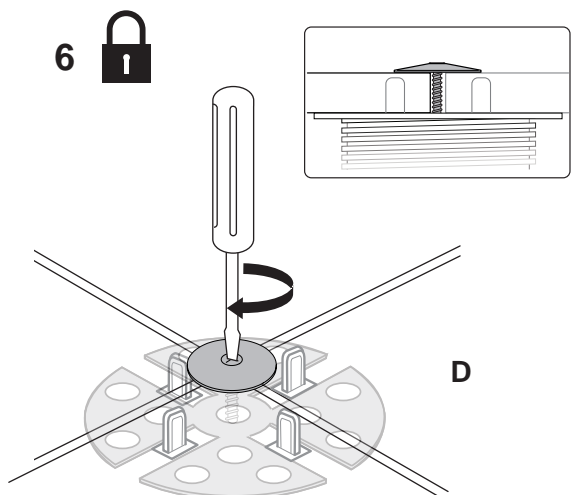
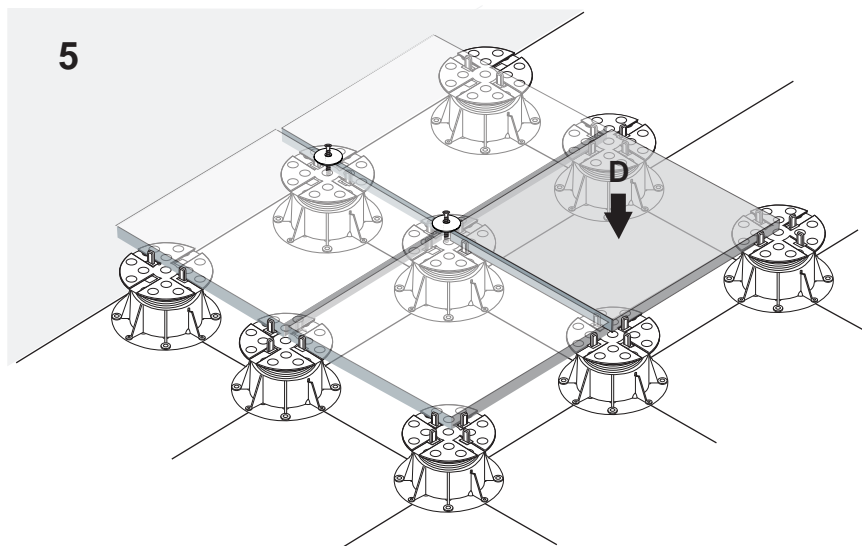
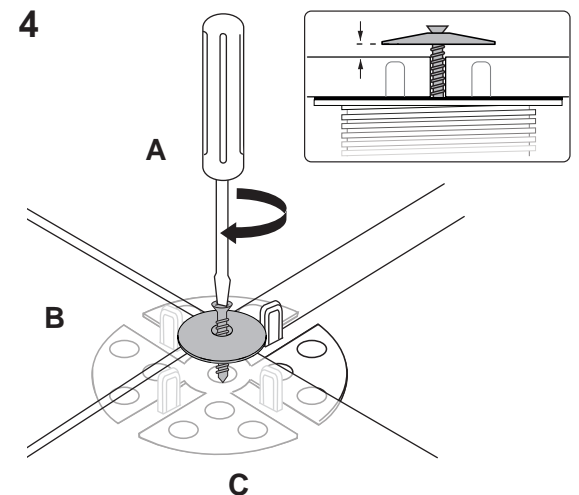
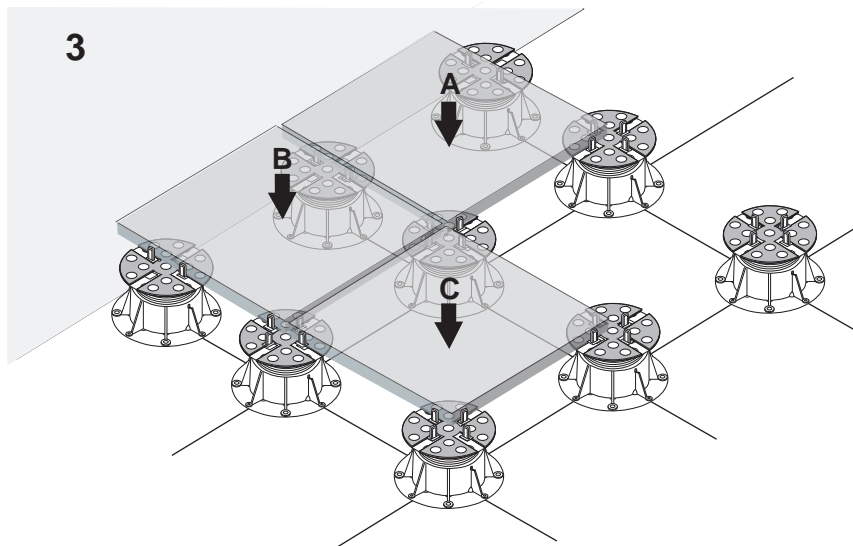
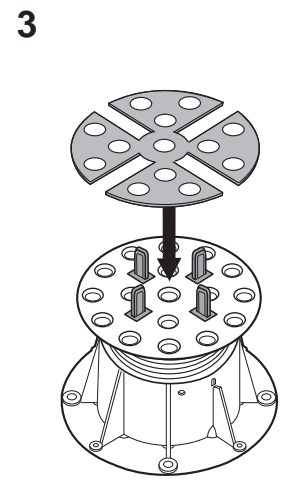
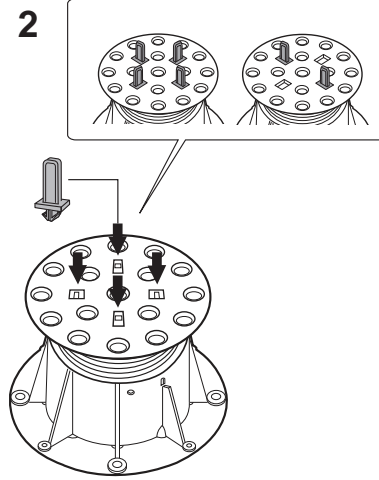
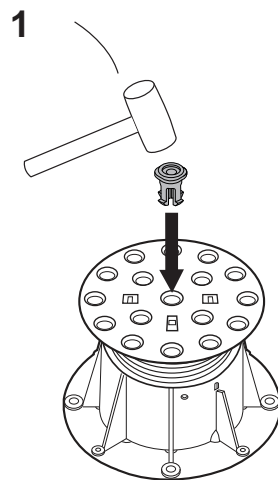
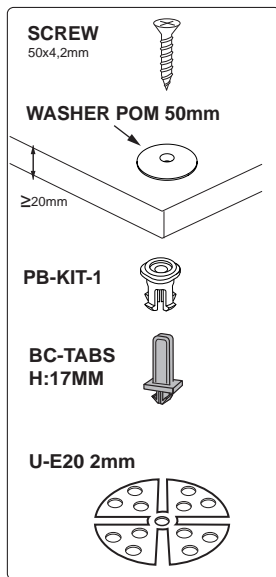

7

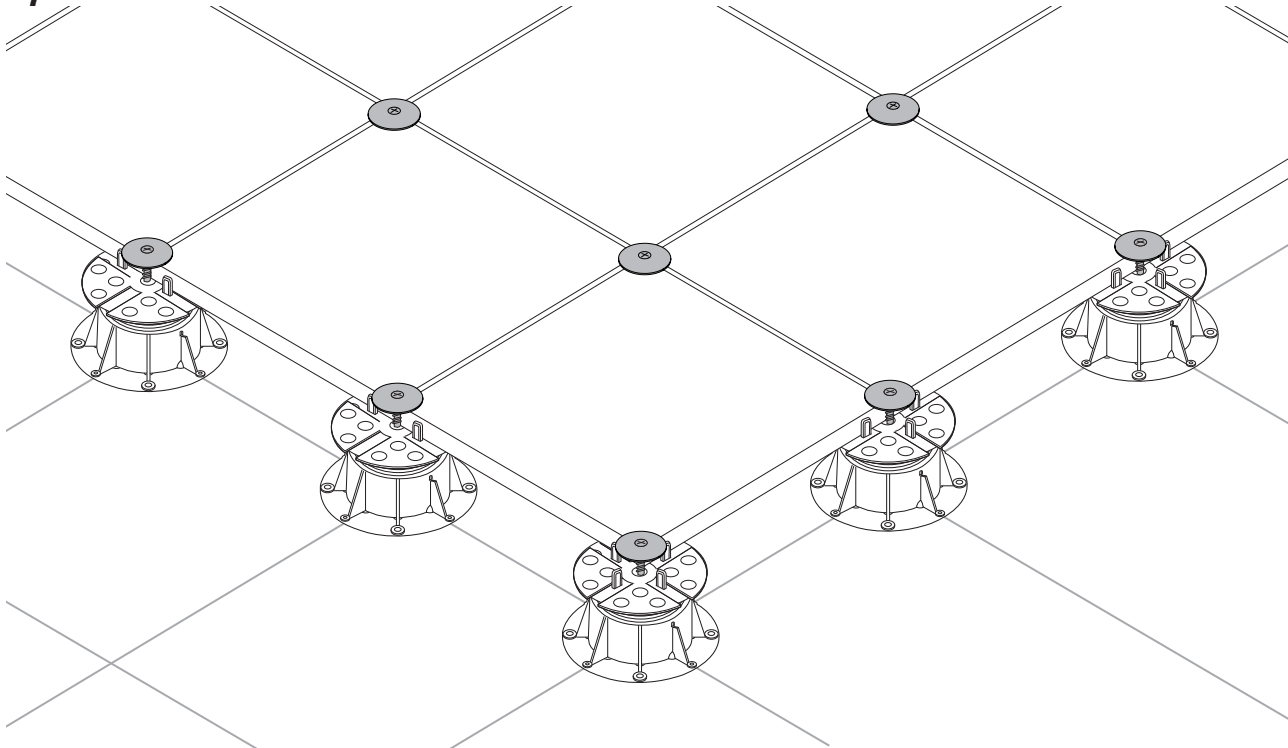

8

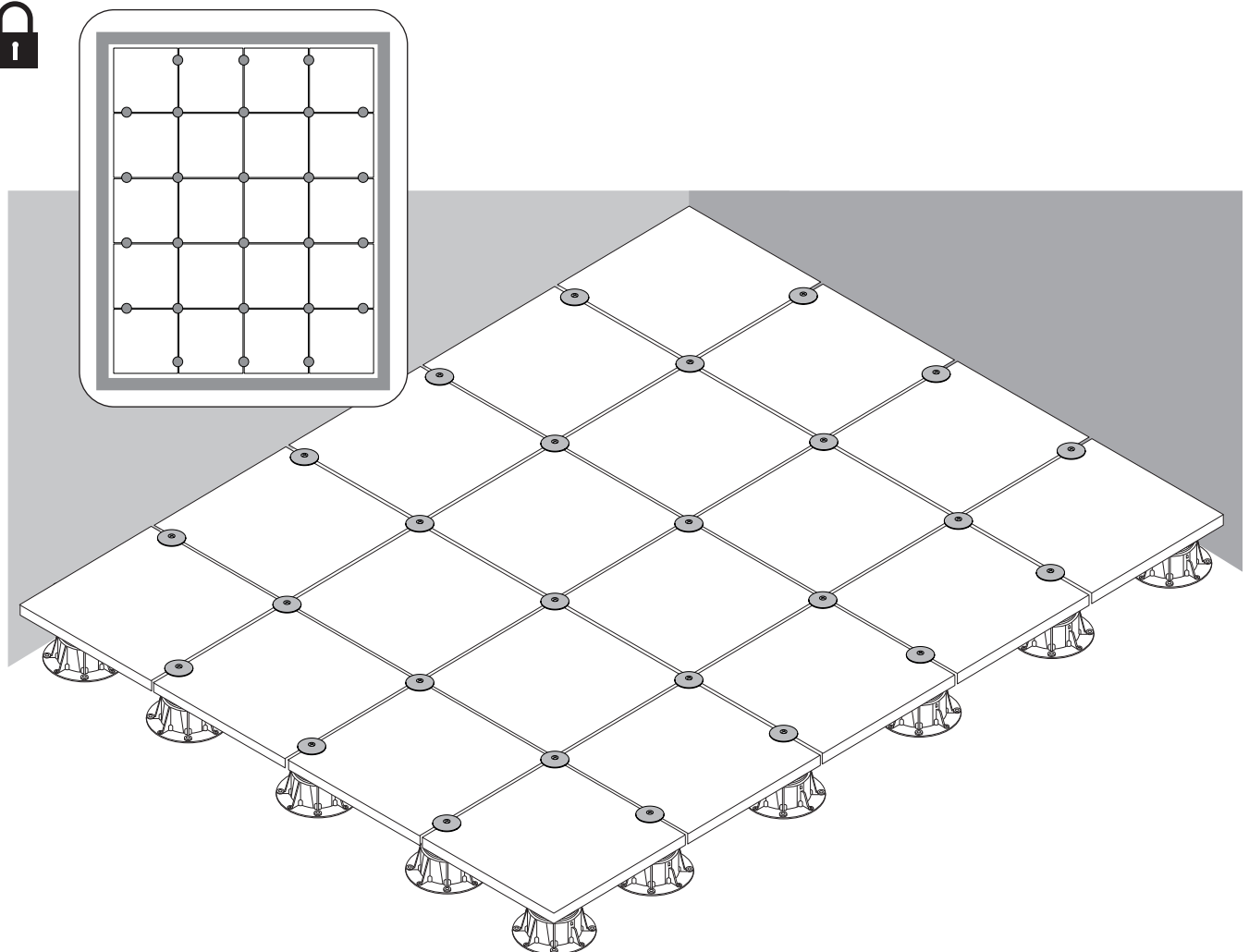

# Installation BC-KIT-WR





**BPI-T 05 – REV 03**

**Traction tests BC-KIT-WR**

*Buzon Pedestal International*

## **Objet : Traction tests BC-KIT-WR**

### **1. Introduction**

As part of the creation of a complete range of Wind-Resistant systems, we have studied the accessories and options available to us for the BC series.

### **2. Tested products and results**

1. We have the possibility of using the PB-KIT-1 with the U-Washer-Vis and the U-Washers.

Traction tests have already been carried out, firstly with PB-KIT-1 bonded to the pedestal with 3M Type 8005 glue. The results in this case range from 73 to 110 kg. Secondly, the PB-KIT-1 is not glued and the results oscillate between 57 and 63 KG at the tearing off.

2. We recently re-tested the PB-KIT-1 without glue. These tests show that it is possible that the results oscillate between 36 and 50 kg.

**To get the Buzon security value, divide the load indicated by 2.**

*Please find SIRRIS reports page 2-8/8*

Haenen Pierre

### 3. Appendix

#### Tests reports of SIRRIS

1.

 <b>sirris</b> driving industry by technology	
<b>Tests Report</b>	<b>Réf: 4-2382</b>
<b>Company : Buzon</b>	
<b>CONCERNING : Tear Tests on Pedestals</b>	
<hr/>	
<b>Sample type</b>	
Receipt date : 30/11/2015	
Client reference : Serie BC 2 – Plug Meiser glued wit 3M type 8005 Serie BC 2 – Plug Meiser non glued Serie PB 1 – Plug Vetedy glued with 3M type 8005 Serie PB 1 – Plug Vetedy non glued	
Sirris reference : Idem	
<b>Samples conditioning</b>	
According to the normal laboratory atmosphere: European standard ISO 291 Temperature: 23°C – Humidity: 50%	
<b>Analysis</b>	
Tear Tests on central part of the pedestal	
<b>Date des essais</b>	
2015/12/14	
<b>Operator</b>	
F. Schoumaker	

page 2/5

Buzon 4-2382 Rapport labtool SI S0251



driving industry by technology

#### Methodology

**Machine used for the tear tests: class: 0.5**

**Instron Corporation** Interface type : Series 4500

**Automatized materials tests system: Series IX 7.34.00**

The 10 kN load cell calibration certificate and the crosshead speed and displacement calibration certificates are valid.

#### Tear tests

Machine parameters :

Machine Instron 4507

Test speed : 10mm/min

Humidity ( % ) : 50

Temperature : (Deg C) : 23



page 3/5



## Résultats

### Serie PB 1 - Plug Vetedy

Mounting with Würth Inox screw - screw tightening at 20mm - 8 turns



### Serie PB 1 - Plug Vetedy

Reference	Tests 1 Screwed Load pullout in daN	Tests 2 Screwed Load pullout in daN	Tests 1 Unscrewed Load pullout in daN	Tests 1 Unscrewed Load pullout in daN	Tests 1 Head only Load pullout in daN
Glue SM type 8005	73	82	110	105	77
not glued	57	62	63	60	60



Rupture by tearing of the small stops of the black clip for all tests

Nb: The test results are only valid for the tested samples

page 5/5

2.



Monsieur Haenen  
Société Buzon Pedestal International  
ZI des Hauts Sarts  
Zone 1  
Prolongement de l'Abbaye 131  
4040 Herstal

#### Report

Dear Sir,

Following your analysis request, please find enclosed the results of the tear tests.

We stay at your disposal for any complementary information.

Best regards,

F. Schoumaker  
Responsible for the project

M. Gasparini  
Laboratory Technical manager

#### Remarks

The here-above tests results may be published or communicated provided 'test realised in Sirris' is mentioned.

Test results are valid only for the tested samples.

Liège Science Park  
Rue du Bois Saint-Jean 12  
BE-4102 Seraing  
tél. : +32 4 361 87 00  
fax : +32 4 361 87 02  
info@sirris.be  
www.sirris.be

Your reference:  
Arrachement

Our reference:  
17-2269 Labtool S170186

contact:  
Francine Schoumaker  
+32 477 841032  
francine.schoumaker@sirris.be  
Liège  
19/06/2017

## Tests report

Ref: 17-2269

Company : Buzon

Concerning : Tear tests

---

### Samples type

Receipt date : 2017/07/26- With customers

Client reference:   BC 2 - Washer Inox  
                          BC 3 - Washer POM

Sirris reference : Idem

### Samples conditioning

According to the laboratory normal atmosphere: European standard ISO 291  
Temperature: 23 $\pm$ 2C - Humidity: 50 $\pm$ 5%

### Analysis

Tear tests

Operator  
F. Schoumaker

Tests date  
2017/06/16

Sampling  
Pedestals tested as received



driving industry by technology

#### Methodology

Machine used for the tear tests : class : 0.5

Instron Corporation interface type : Series 4500

Automatized materials tests system: Series IX 7.34.00

The 10kN load cell calibration certificate and the crosshead speed and displacement calibration certificates are valid and can be sent on request.

#### Tensile/Tear tests

##### Machine parameters

Machine Instron 4507

Humidity( % )50

Test speed : 10mm/min

Temperature : (Deg C) : 23

#### Result

BC 2 - Washer Inox

Tear strength 36.62 daN or 366.2 N



**Result**

**BC 3 - Washer POM**

**Tear strength 48.39 daN or 483.9 N**



**Nb:** Tests results are valid only for the tested samples