



# Technical Data Sheet

## A-PED-JOIST 20mm Aluminium Joist

### COMPONENTS

The A-PED-JOIST is composed of:  
1 x Piece

### CHARACTERISTICS

Weight: 2.163kg  
Height: 20mm  
Width: 65mm  
Length: 3000mm  
Fire-Rating: Class A1 according to BS EN 13501-1

### MATERIAL

Designed and manufactured in UK  
Aluminium  
Resistant to weathering and a wide range of chemicals

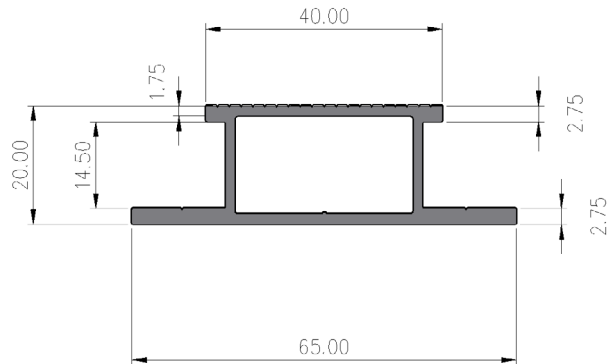

CAD files are available for download from our [Resource Centre](#)

### APPLICATIONS

The A-PED-JOIST is a 20mm joist for use with the A-PED pedestal range when a rail or joist system is required. The shape of the joist means that it can be easily screwed to the head of the pedestal. If spacer tabs are required, the A-PED-TABS-PLATE-3MM can be used.

### JOIST AND PEDESTAL CENTRES - DECKING

For decking recommended distance between A-PED-JOISTS for weight loads – centre to centre:

- Commercial settings – 350mm
- Domestic settings – 500mm

Pedestal Centres - 400mm

Please contact us if you require information for paving layouts

### PACKAGING

Packaging	A-PED-JOIST	Unit
Weight per Piece	2.163	kg
Pieces per Pallet	180	qty
Pallet Weight	389	kg
Pallet Dimension	57x57x300	cm



### SAFETY INSTRUCTIONS

Buzon pedestals and accessories are designed to support external raised floors for pedestrian traffic only and are not designed to support or be subjected to moving and/or vibrating machinery & equipment, including maintenance, cleaning vehicles, automobiles and other similar equipment.

**Contact us if you require further technical support or advice**  
[buzonuk.com](http://buzonuk.com) - [info@buzonuk.com](mailto:info@buzonuk.com) - +44 (0)20 8614 0874

Buzon has a policy of continuous improvement and reserves the right to modify, revise or change the above specifications without notice. This brochure is for descriptive purpose only and is based on the product as on the date of publication of this information.